



Meetings That Hit Big

Turning Stone[®]
MEETINGS

World-Class Hospitality in the
Heart of Upstate New York



A Destination That Inspires

Upstate New York's natural beauty blends seamlessly with world-class amenities at Turning Stone Resort Casino.

- 225,000 sq. ft. of meeting space
- 1,046 guest rooms, from relaxed to lavish
- Flexible, contiguous rooms for general sessions and breakout sessions
- 20+ dining options, from fine dining to quick and convenient
- Two luxury spas and wellness center
- Three award-winning golf courses
- 10+ nightlife options
- Centrally located — easy travel by air, car or rail



888.361.7958 · meetings@turningstone.com

Getting Here

Conveniently located in Upstate New York, our resort is nestled between Syracuse and Utica — making travel simple, whether you're arriving from within or outside of the Empire State.

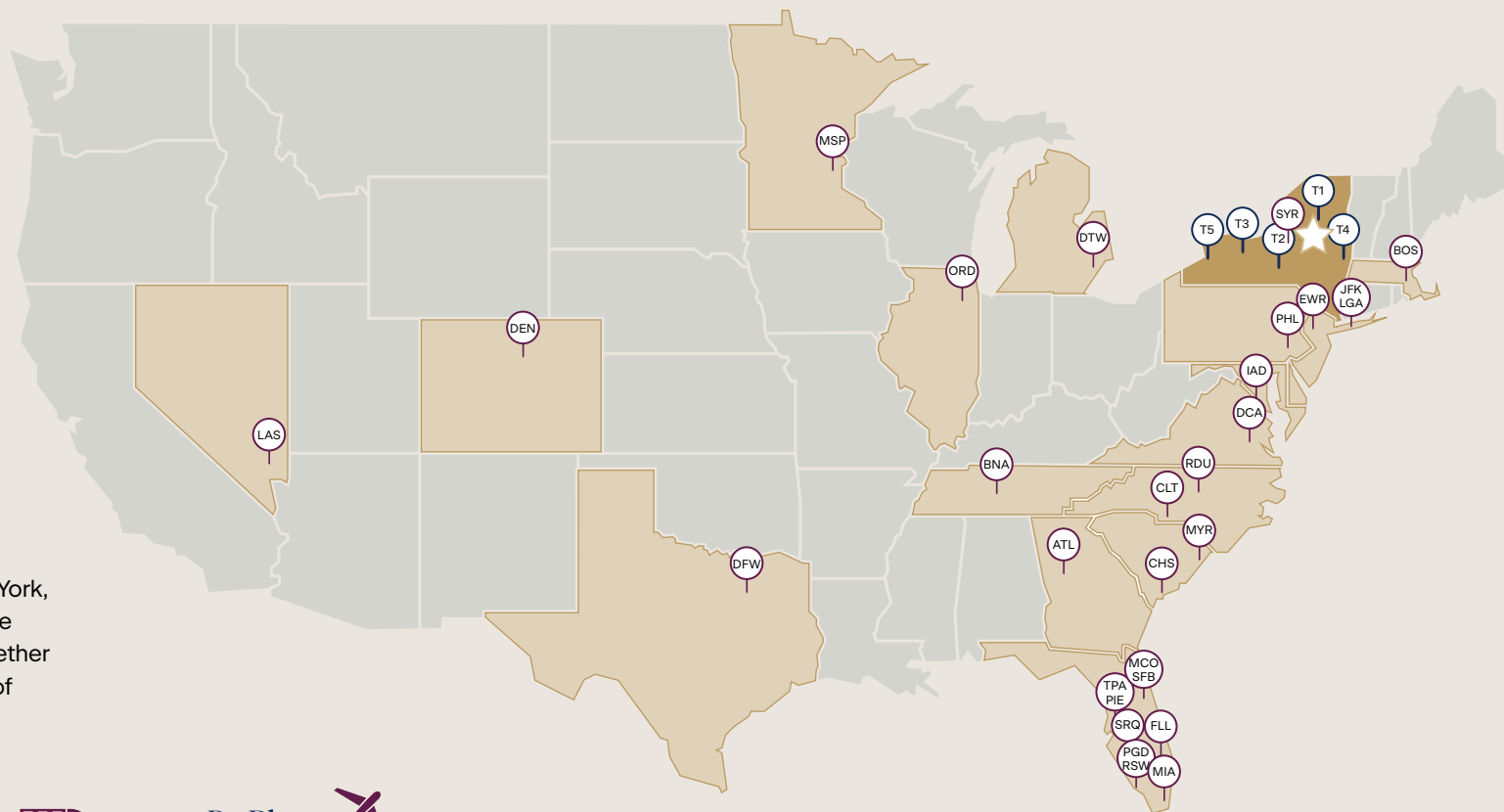

By Car

Located right off of I-90, your attendees can enjoy the beautiful scenery in every direction when visiting by car.

Ample complimentary parking is available in our parking garage and resort lots. There is a shuttle provided for lots farther out. Valet parking is also available.

By Train

Arrivals from Buffalo, Rochester, Albany, New York City (New York Penn Station), Yonkers and more.

-  **T1** ROME TRAIN STATION
Rome, New York
-  **T2** SYRACUSE REGIONAL TRANSPORTATION CENTER
Syracuse, New York
-  **T3** LOUISE M. SLAUGHTER STATION
Rochester, New York
-  **T4** ALBANY-RENSSELAER STATION
Albany, New York
-  **T5** BUFFALO EXCHANGE STREET STATION
Buffalo, New York

By Plane

Turning Stone Resort Casino is just 30 minutes from Syracuse Hancock International Airport (SYR), which offers 28 direct flight destinations with 9 different airlines. Plus, guests can book a ride share for easy, direct transport to/from the airport.

Non-Stop Flights

- | | | | |
|---|---|---|---|
|  JFK JOHN F. KENNEDY INTERNATIONAL AIRPORT
New York City, New York |  RDU RALEIGH-DURHAM INTERNATIONAL AIRPORT
Morrisville, North Carolina |  ORD O'HARE INTERNATIONAL AIRPORT
Chicago, Illinois |  FLL FORT LAUDERDALE-HOLLYWOOD INTERNATIONAL AIRPORT
Fort Lauderdale, Florida |
|  LGA LAGUARDIA AIRPORT
Queens, New York |  CLT CHARLOTTE DOUGLAS INTERNATIONAL AIRPORT
Charlotte, North Carolina |  MCO ORLANDO INTERNATIONAL AIRPORT
Orlando, Florida |  MIA MIAMI INTERNATIONAL AIRPORT
Miami, Florida |
|  EWR NEWARK LIBERTY INTERNATIONAL AIRPORT
Newark, New Jersey |  MYR MYRTLE BEACH INTERNATIONAL AIRPORT
Myrtle Beach, South Carolina |  SFB ORLANDO SANFORD INTERNATIONAL AIRPORT
Sanford, Florida |  MSP MINNEAPOLIS-SAINT PAUL INTERNATIONAL AIRPORT
Saint Paul, Minnesota |
|  BOS BOSTON LOGAN INTERNATIONAL AIRPORT
Boston, Massachusetts |  CHS CHARLESTON INTERNATIONAL AIRPORT
North Charleston, South Carolina |  TPA TAMPA INTERNATIONAL AIRPORT
Tampa, Florida |  DFW DALLAS FORT WORTH INTERNATIONAL AIRPORT
Dallas, Texas |
|  PHL PHILADELPHIA INTERNATIONAL AIRPORT
Philadelphia, Pennsylvania |  ATL HARTSFIELD-JACKSON ATLANTA INTERNATIONAL AIRPORT
Atlanta, Georgia |  PIE ST. PETE-CLEARWATER INTERNATIONAL AIRPORT
Clearwater, Florida |  DEN DENVER INTERNATIONAL AIRPORT
Denver, Colorado |
|  IAD DULLES INTERNATIONAL AIRPORT
Dulles, Virginia |  BNA NASHVILLE INTERNATIONAL AIRPORT
Nashville, Tennessee |  SRQ SARASOTA BRADENTON INTERNATIONAL AIRPORT
Sarasota, Florida |  LAS HARRY REID INTERNATIONAL AIRPORT
Paradise, Nevada |
|  DCA RONALD REAGAN WASHINGTON NATIONAL AIRPORT
Arlington, Virginia |  DTW DETROIT METROPOLITAN WAYNE COUNTY AIRPORT
Detroit, Michigan |  PGD PUNTA GORDA AIRPORT
Punta Gorda, Florida |  RSW SOUTHWEST FLORIDA INTERNATIONAL AIRPORT
Fort Myers, Florida |



Lodging That Elevates

The Crescent

This stunning new hotel elevates our guests to new heights of extravagance and comfort, featuring a signature indoor-outdoor seafood restaurant.

The Lodge

Our gorgeous woodland retreat offers elegant luxury suites with separate workspaces.



The Tower

Contemporary, stylish rooms and suites with panoramic views — topped with the award-winning TS Steakhouse on the penthouse floor.

The Brook

Located at the heart of the resort, The Brook offers rooms and suites with convenient access to meetings, dining and more.

Sandstone Hollow Inn

This relaxed, friendly inn is a short, complimentary shuttle ride from the main campus.

The Inn

Enjoy relaxed rooms and a welcoming staff. Complimentary services include breakfast and a shuttle to the casino.





Meeting Spaces That Impress

225,000 square feet of flexible meeting space, with unobstructed views for impactful general sessions and breakouts.

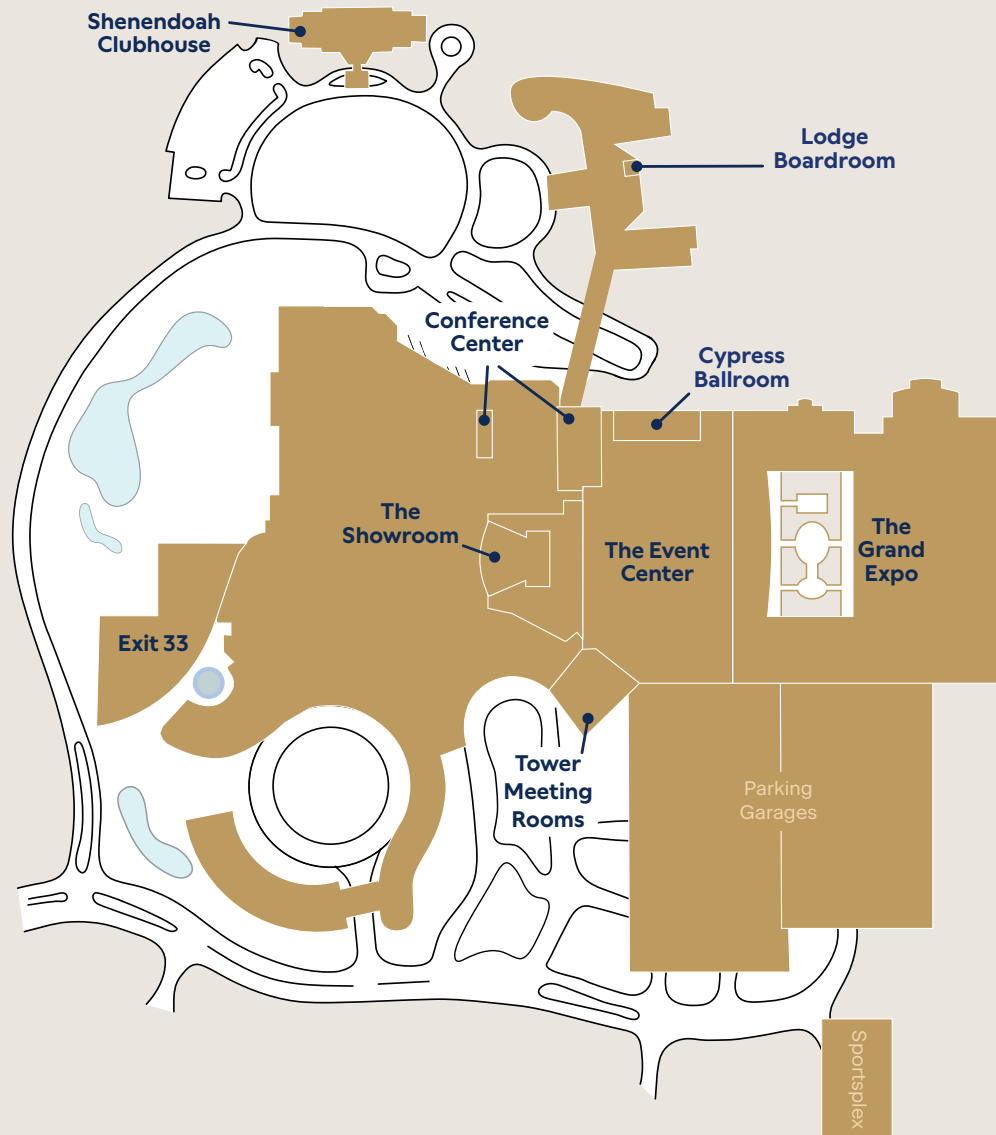



The Grand Expo

This majestic, state-of-the-art addition features grand ballrooms, luxe breakout rooms, expansive, pillarless spaces, towering ceilings and natural light — and spectacular outdoor event spaces.

- Flexible meeting spaces, boardrooms and ballrooms, including the 30,000 sq. ft. Grand Ballroom
- Courtyard totaling 24,219 sq. ft.
- Dedicated registration desks
- Connectivity to The Crescent and indoor parking



The Event Center

A truly majestic space, The Event Center offers a 30,000-square-foot exhibit floor that can be configured to match your most specific needs. It also includes the 19,000-square-foot Atrium ideal for registration and pre-function activities.

- Including the Atrium, 49,000+ sq. ft.
- In-house public address system for the event floor
- In-floor power supply
- Hosts up to 1,200 guests for a plated meal
- Accommodates up to 180 10x10' booths

The Showroom

Ideal for keynote addresses, The Showroom offers state-of-the-art lighting and sound, a luxurious bar and exceptionally comfortable theater seating.

- Stadium-style seating
- Accommodates up to 650 guests





The Conference Center

Large or small, your group will find the perfect fit. There's plenty of room for keynotes, exhibits, seminars, meals, meetings and even company celebrations — all in a grand ballroom setting.

- 22,500+ sq. ft.
- State-of-the-art technology and in-house AV support
- Breakout meeting rooms with flexible configurations
- Accommodates banquets for up to 800 guests
- Ground-level load-in access
- Private registration desk



Cypress Ballroom

Adjacent to The Event Center, this natural light-filled space works exceptionally well for large meetings, elegant corporate celebrations and effective training events.

- 5,700+ sq. ft.
- Flexible configuration – up to five breakout spaces
- Beautifully furnished

Tower Meeting Rooms

Perfect for small-group discussions, seminars and boardroom-style meetings, The Tower lends your gathering the right combination of intimacy, convenience and sophistication.

- Seven fully equipped boardroom-style meeting rooms from 400 to 900+ sq. ft.
- Easy access to the parking garage, the hotels, Conference Center and dining





Shenendoah Clubhouse

The Clubhouse is a favorite setting for executive board retreats, incentive meetings and corporate celebrations. This one-of-a-kind meeting space is steps away from the main resort.

- 5,900 sq. ft. that can be used as a single session or three breakouts
- Expansive room with fireplace and balcony
- Convenient self-parking
- Outdoor patio
- Adjacent to The Lodge
- Picturesque fairway views

The Lodge Boardroom

The Lodge Boardroom provides a serene space with private access to the scenic Great Lawn. The Boardroom is fully loaded with high-tech amenities and expert staff ready to assist.

- Seats up to 14
- Executive leather chairs
- Extensive charging ports
- Built-in telecommuting technology
- Large LCD video monitor
- Automated black-out shades for enhanced presentation clarity

The Event Center

Specifications

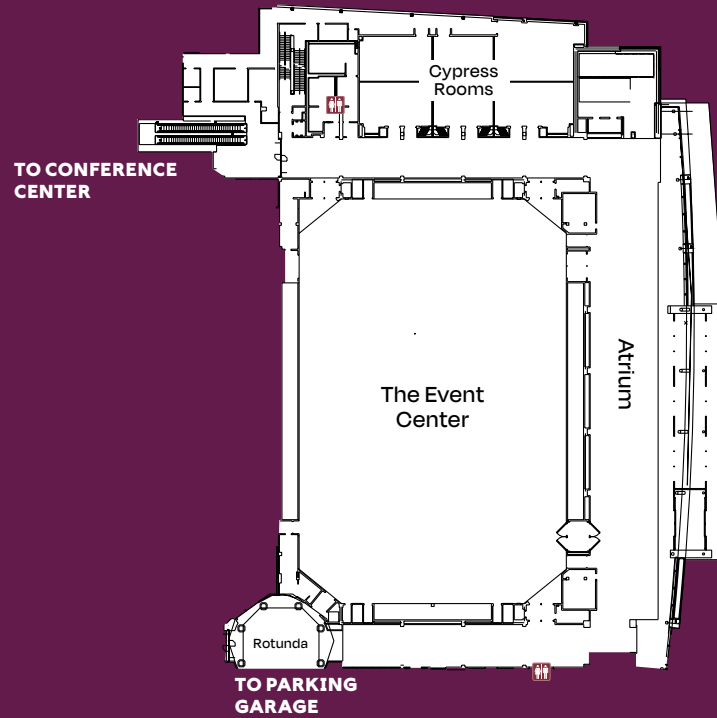

ROOM	SQ. FT.
The Event Center	29,868
Atrium	18,981

CEILING HEIGHT — 12 - 55 FEET

The Conference Center

Specifications

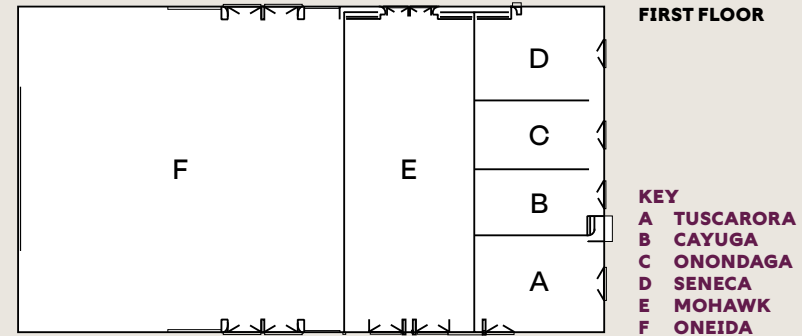

ROOM	DIMENSIONS	THEATER	CLASSROOM	BANQUET	SQ. FT.
Tuscarora	37'x55'	126	72	60	1,579
Cayuga	27'x51'	108	63	50	1,337
Onondaga	26'x51'	108	63	50	1,252
Seneca	33'x51'	126	72	60	1,609
Mohawk	116'x45'	540	270	230	5,212
Oneida	132'x101'	624	514	400	11,465
Combined	119'x196'	1,632	1,054	850	22,500

MINIMUM CEILING HEIGHT — 12 - 16 FEET

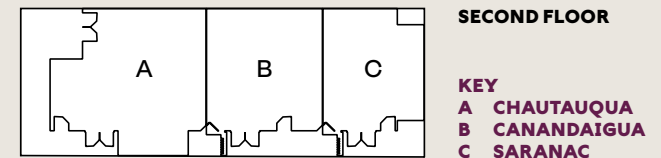

ROOM	DIMENSIONS	THEATER	CLASSROOM	BANQUET	SQ. FT.
Chautauqua	31'x32'	49	27	40	836
Canandaigua	25'x24'	40	27	30	618
Saranac	25'x21'	45	27	20	499
Combined	36'x80'	144	81	90	1,953

MINIMUM CEILING HEIGHT — 10 FEET

Cypress Ballroom

Specifications

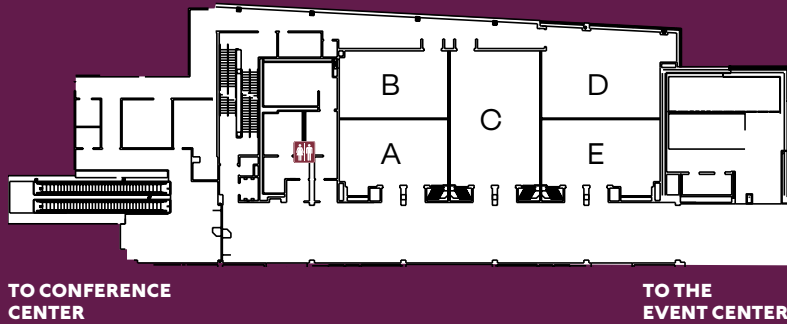

ROOM	DIMENSIONS	THEATER	CLASSROOM	BANQUET	SQ. FT.
Cypress A	23'x38'	50	36	40	933
Cypress B	23'x38'	60	36	30	893
Cypress C	47'x31'	126	72	60	1,509
Cypress D	23'x38'	72	57	40	1,346
Cypress E	23'x38'	50	42	40	1,024
Cypress A+B	47'x38'	126	84	60	1,826
Cypress D+E	56'x41'	180	108	90	2,370
Cypress Total	112'x56'	450	306	230	5,705

CEILING HEIGHT — 12 - 55 FEET

The Tower Meeting Rooms

Specifications

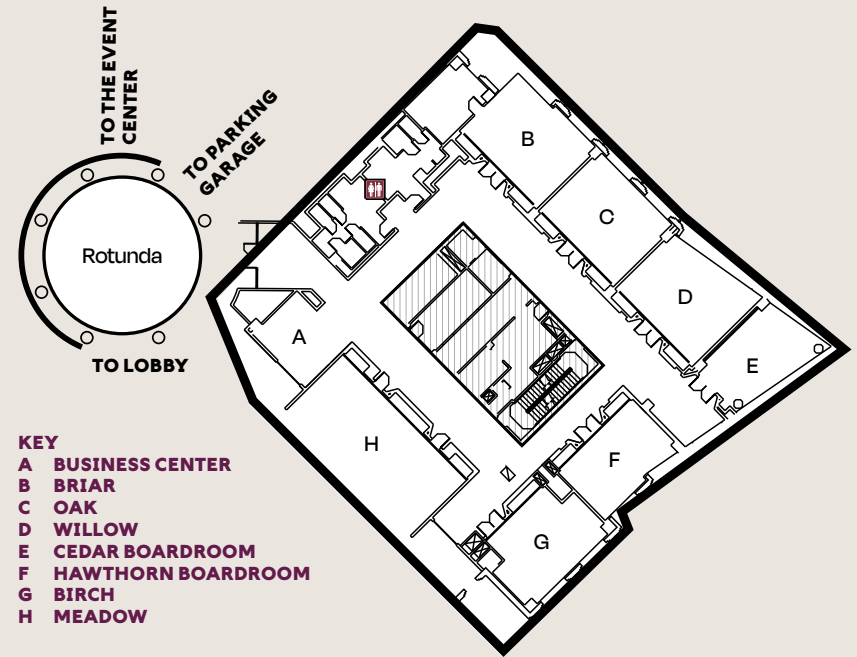

ROOM	DIMENSIONS	THEATER	CLASSROOM	BANQUET	SQ. FT.
Briar	23'x26'	50	22	30	581
Oak	23'x26'	46	24	30	571
Willow	26'x35'	46	24	30	587
Cedar	27'x19'	N/A	N/A	N/A	407
Hawthorn	19'x25'	N/A	N/A	N/A	459
Birch	22'x27'	34	18	20	513
Meadow	24'x43'	75	36	40	944

MINIMUM CEILING HEIGHT — 10 FEET

Shenendoah Clubhouse

Specifications

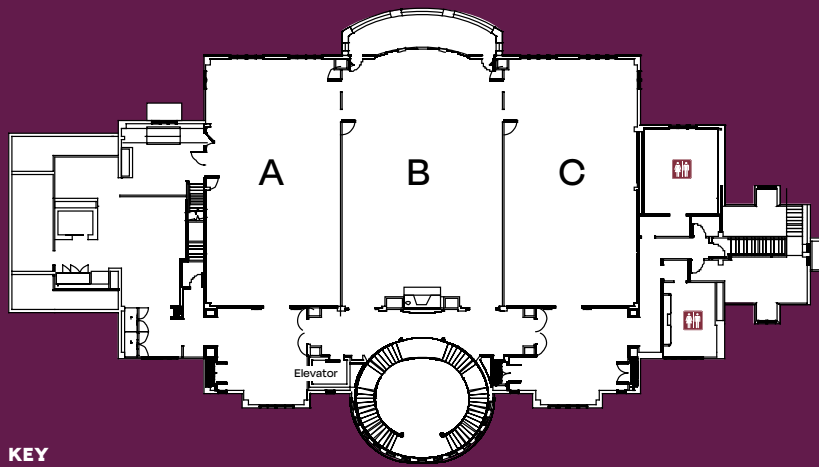

- KEY**
A APPALACHIAN
B ADIRONDACK
C CATSKILL

ROOM	DIMENSIONS	THEATER	CLASSROOM	BANQUET	SQ. FT.
Appalachian	32'x58'	154	84	70	1,851
Adirondack	38'x58'	176	84	90	2,221
Catskill	32'x58'	154	84	70	1,830
Combined	58'x102'	414	216	230	5,902

MINIMUM CEILING HEIGHT — 10 FEET

The Lodge Boardroom

Specifications

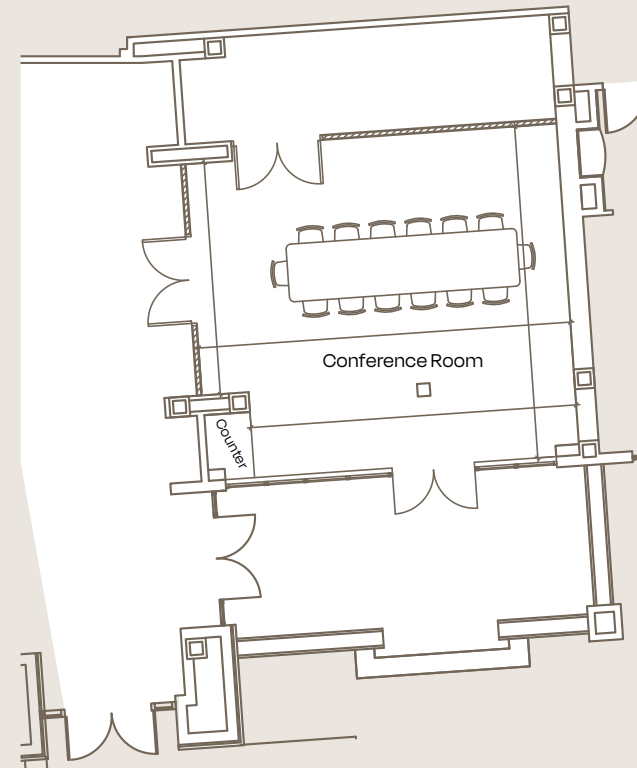

DIMENSIONS	CAPACITY	SQ. FT.
22'x25'	14	550

MINIMUM CEILING HEIGHT — 10 FEET

The Grand Expo Meeting Rooms Specifications

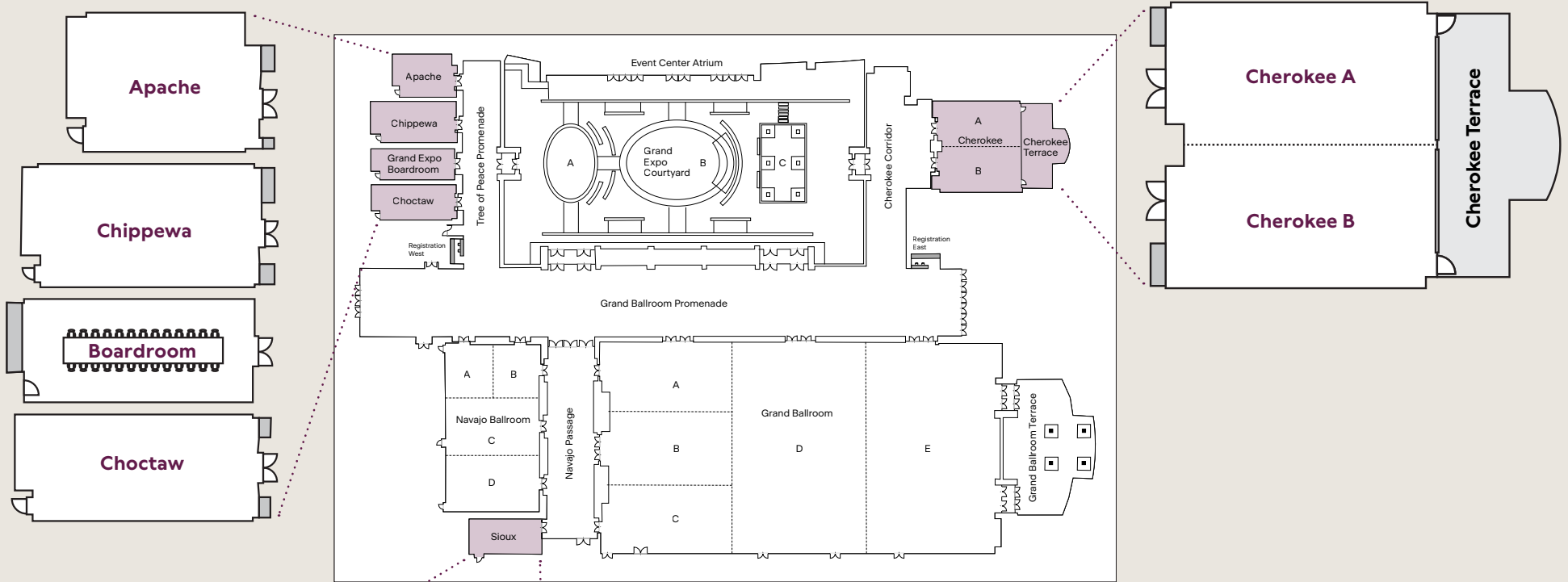

ROOM	DIMENSIONS	THEATER	CLASSROOM	BANQUET	BOARD	SQ. FT.
Apache	39' x 26'	63	54	40	-	924
Chippewa	28' x 58'	110	81	80	-	1,533
Grand Expo Boardroom	20' x 48'	-	-	-	26	901
Choctaw	21' x 50'	80	48	40	-	997
Sioux	25' x 50'	100	72	60	-	1,183
Cherokee	50' x 51'	194	144	140	-	2,421
Cherokee A	25' x 51'	100	72	60	-	1,202
Cherokee B	25' x 51'	100	72	60	-	1,218
Cherokee Terrace	52' x 24'	-	-	-	-	909

MINIMUM CEILING HEIGHT — 14 FEET

The Grand Expo Navajo Ballroom Specifications

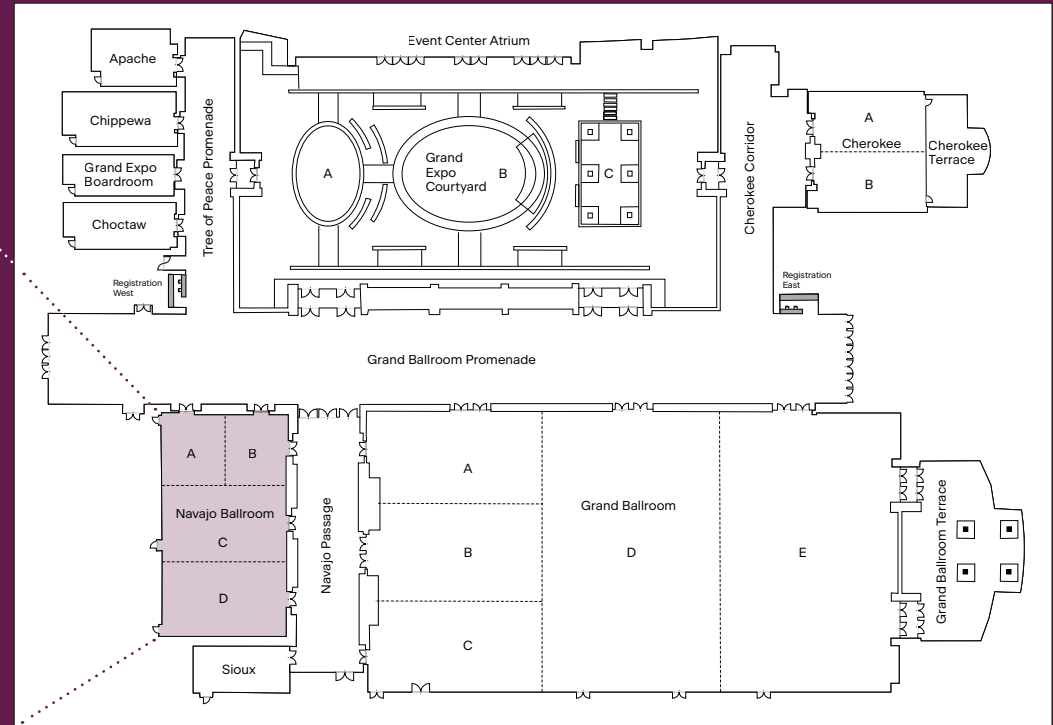
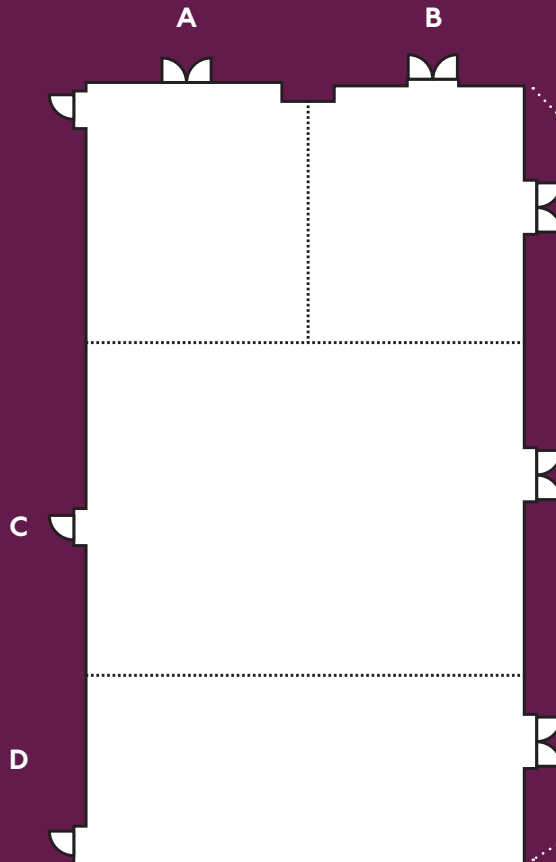

ROOM	DIMENSIONS	THEATER	CLASSROOM	BANQUET	SQ. FT.
Navajo Ballroom	100' x 59'	380	324	280	5,507
Navajo Ballroom A	33' x 30'	70	45	40	917
Navajo Ballroom B	33' x 28'	70	45	40	895
Navajo Ballroom C	33' x 59'	180	108	80	1,830
Navajo Ballroom D	34' x 58'	180	108	80	1,864
MINIMUM CEILING HEIGHT — 12 FEET 1 INCH					

The Grand Expo Grand Ballroom Specifications

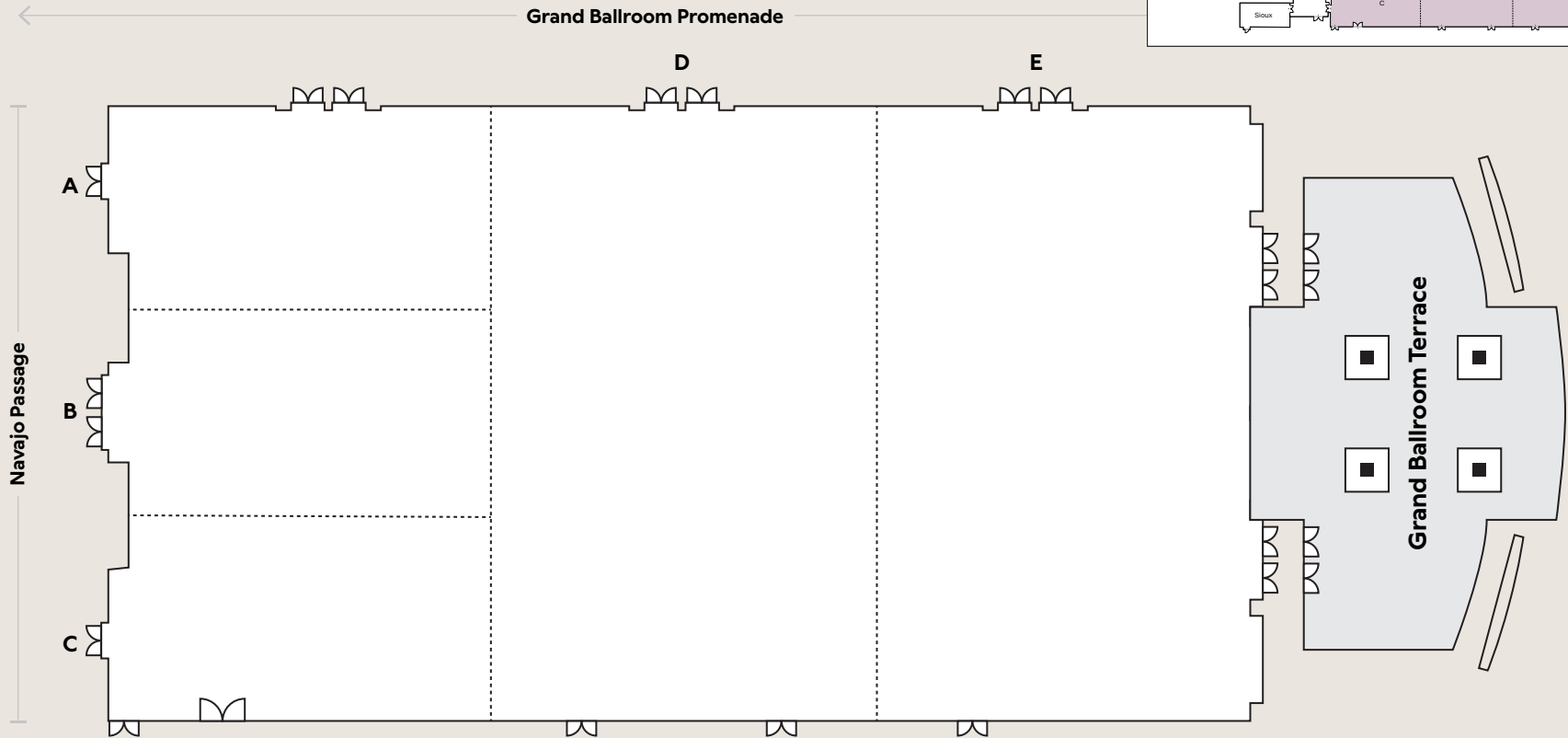
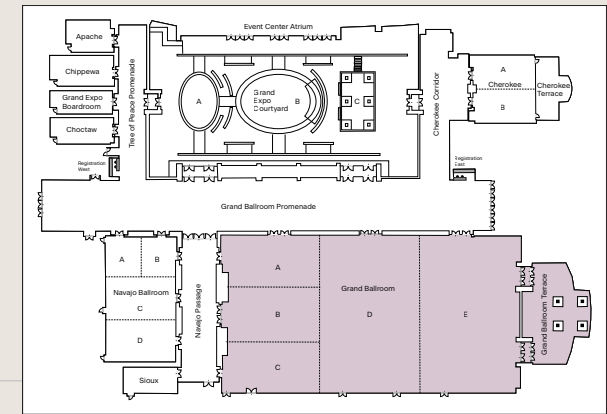

ROOM	DIMENSIONS	THEATER	CLASSROOM	BANQUET	SQ. FT.
Grand Ballroom	124' x 234'	1,880	1,120	1,280	28,397
Grand Ballroom A	41' x 78'	240	144	150	3,100
Grand Ballroom B	41' x 78'	240	144	150	3,096
Grand Ballroom C	42' x 78'	240	144	150	3,118
Grand Ballroom D	124' x 77'	800	480	450	9,528
Grand Ballroom E	124' x 78'	800	480	450	9,556
Grand Ballroom Terrace	82' x 55'	-	-	-	3,352

MINIMUM CEILING HEIGHT — 18 FEET 9 INCHES

The Grand Expo Courtyard Specifications

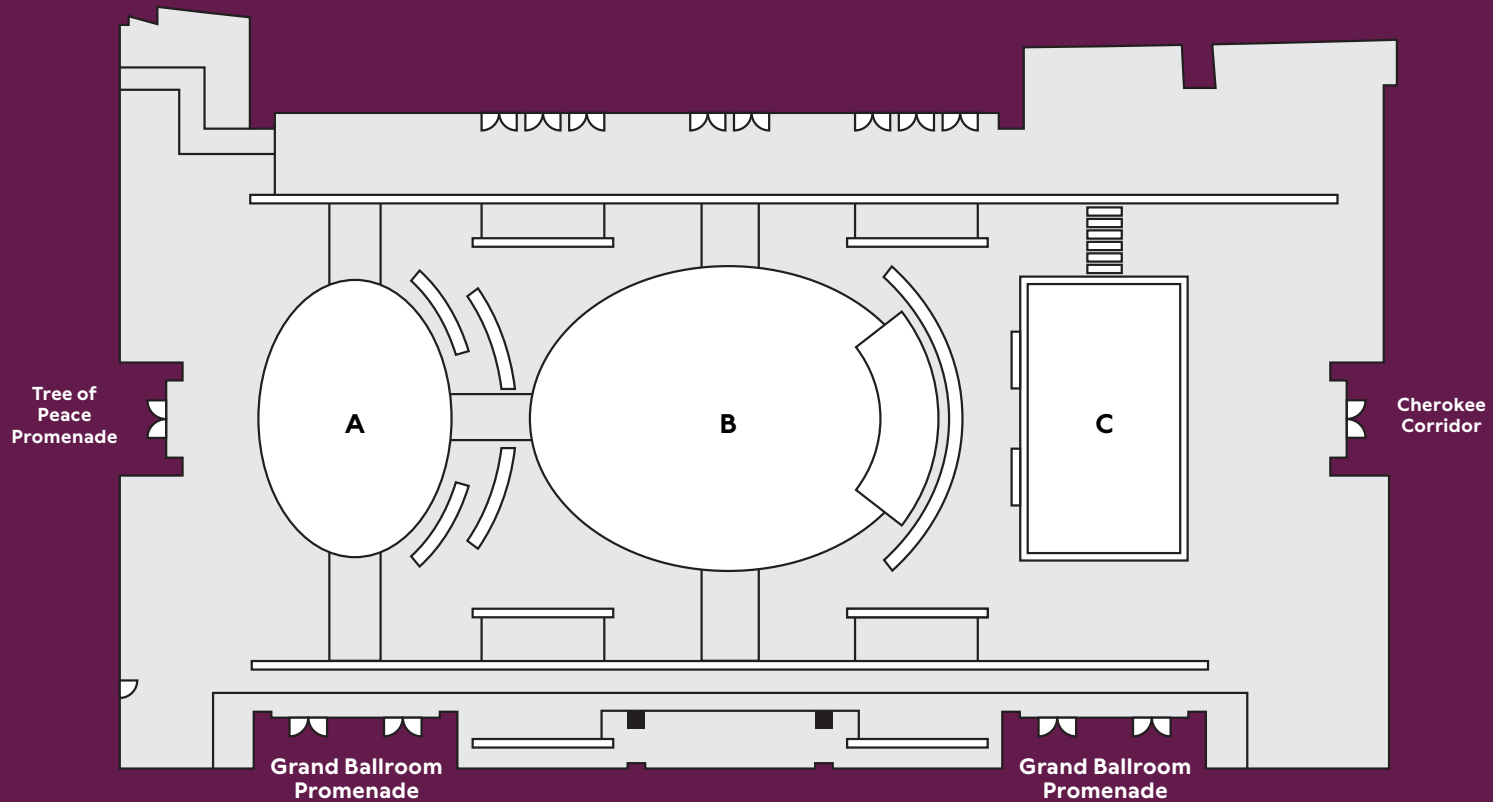
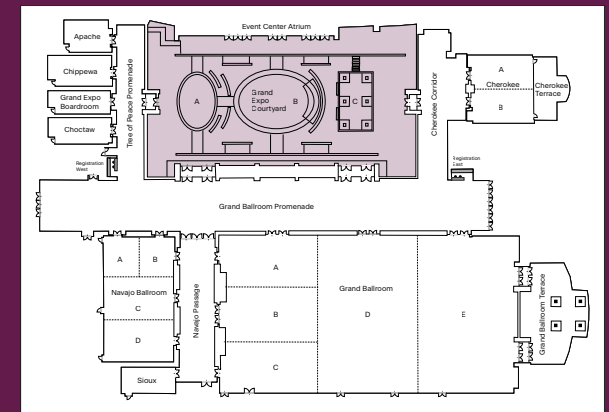

AREA	DIMENSIONS	RECEPTION	SQ. FT.
Grand Expo Courtyard (overall)	130' x 218'	224	24,192
Grand Expo Courtyard A	-	-	1,219
Grand Expo Courtyard B	-	-	2,832
Grand Expo Courtyard C	-	-	1,345



Nightlife at Exit 33

From live rock bands to luxurious lounges, we've got it all when it's time for your team to kick back. Available for private events or eclectic breakout meetings.

Turquoise Tiger

Socialize in style where handcrafted cocktails, trendy live music and an effortlessly glamorous scene surround you.

NY Rec & Social Club

Take game day to the next level at Upstate NY's ultimate sports bar! With great games, epic eats and signature drinks, every moment feels like a win.



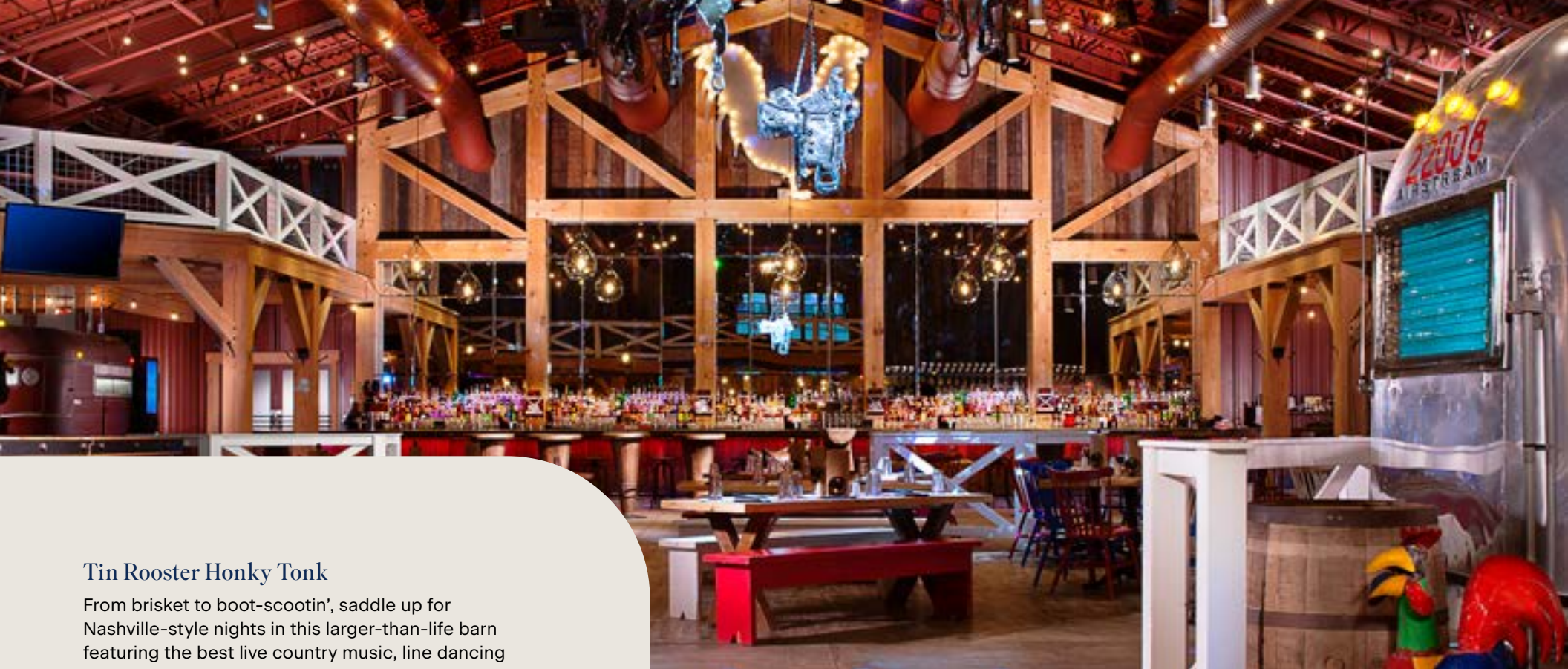

Tin Rooster Honky Tonk

From brisket to boot-scootin', saddle up for Nashville-style nights in this larger-than-life barn featuring the best live country music, line dancing and pit-fired BBQ around.

The Gig

An electric, gritty hangout for bold vibes and big nights. From killer bands to nationally touring DJs, if they're here, they're legends – and on this dance floor, you are too.

Alchemist Bar

Our cocktails transform your evening into something extraordinary. It's the perfect spot for a meet-up or casual sit-and-sip.

Exit 33 Courtyard

Gather on the patio for fresh air, cool cocktails and cornhole under twinkling lights. Open seasonally.



Exit 33

Specifications

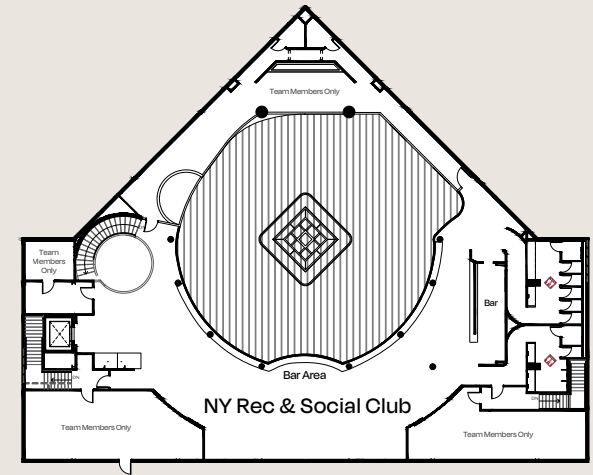
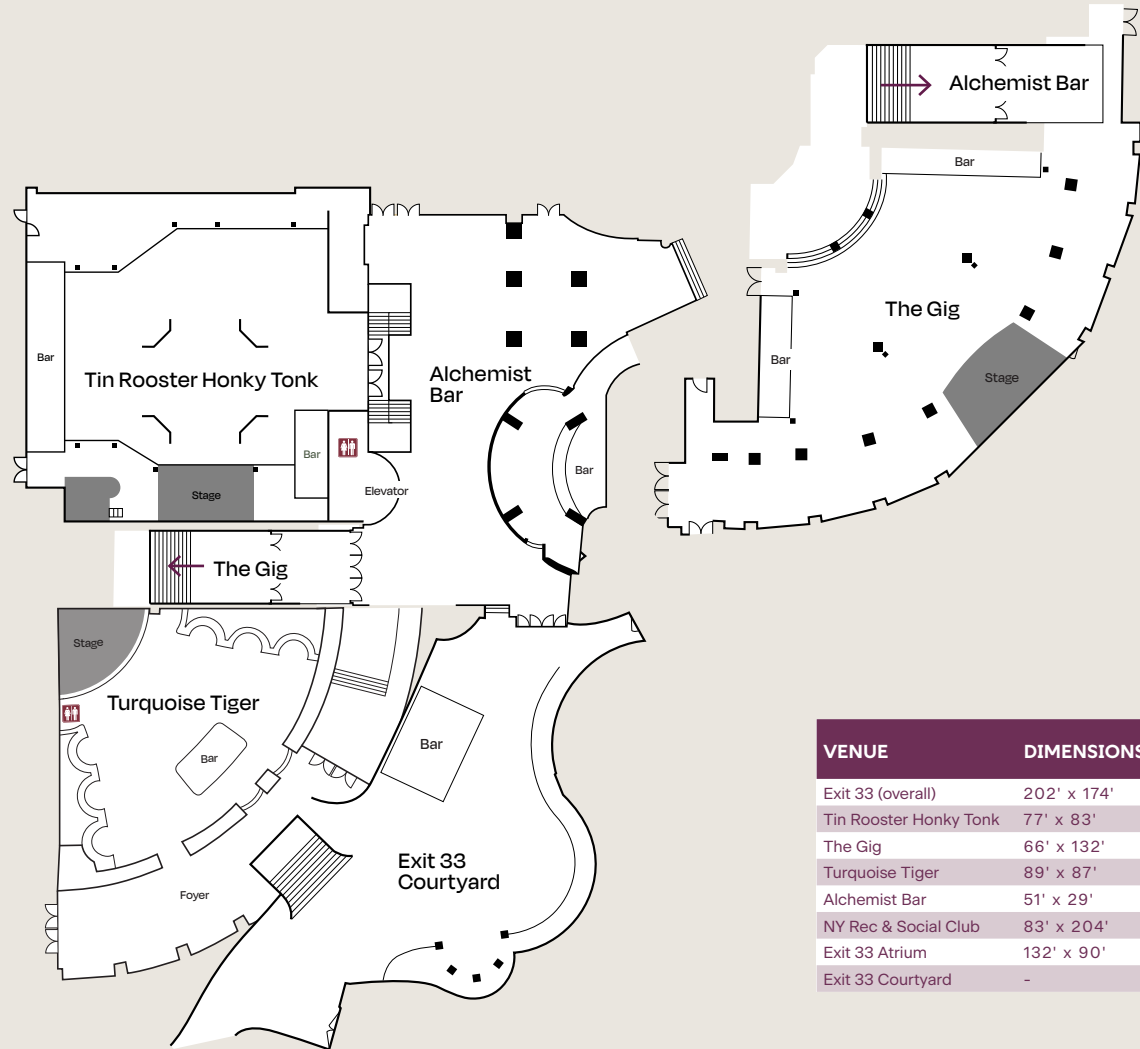

VENUE	DIMENSIONS	PASSED RECEPTION	STATION RECEPTION	BANQUET	SQ. FT.	CEILING HEIGHT
Exit 33 (overall)	202' x 174'	-	-	-	22,306	48'
Tin Rooster Honky Tonk	77' x 83'	200	200	138	4,632	25'
The Gig	66' x 132'	200	200	100	5,599	13'
Turquoise Tiger	89' x 87'	140	120	-	5,633	11'
Alchemist Bar	51' x 29'	150	100	90	958	12'
NY Rec & Social Club	83' x 204'	-	101	-	10,150	39'
Exit 33 Atrium	132' x 90'	-	-	-	5,485	48'
Exit 33 Courtyard	-	150	100	50	-	-

Dining That Wows

Enjoy private group dining and indulge in culinary excellence at your choice of over 20 signature restaurants.

Wildflowers

Honored with the AAA Four Diamond Award and the Forbes Travel Guide Four-Star Award, Wildflowers sets the standard for atmosphere and culinary excellence with locally sourced, seasonal dishes.

TS Steakhouse

Located on the 21st floor of The Tower, TS Steakhouse features classic cuts, chops and cocktails with panoramic views, fine cigars and spirits.

Peach Blossom

Peach Blossom artistically combines Chinese and Thai cuisine with variety, freshness, sweet and spicy flavors.

Pino Bianco

Nestled in the center of the resort, Pino Bianco is an Italian-style restaurant where dinner is served up in a casual yet sophisticated setting.

Salt

This trend-setting restaurant offers four private dining areas and three-season terrace seating.





7 Kitchens

A station-style buffet with a robust menu of global flavors - with custom station options available for your event.

NY Rec & Social Club

Unleash your competitive spirit, savor signature cocktails and win over your hunger. Epic eats, ranging from shareable snacks to gourmet delights, hit the spot every time.

The Food Hall at Turning Stone

Stop in at the Food Hall for six unique dining options ranging from hot corned beef sandwiches to pizza, General Tso's chicken, Philly burgers, fried chicken and quesadillas.

Sushi Sushi

A variety of Sashimi, Nigiri and Maki rolls are handcrafted by our Sushi Chef — featuring his daily selection of the highest-quality fish and steaming Asian Noodles.

Emerald Restaurant

Emerald serves casual fare in a comfortable, relaxed setting. Choose from a classic American menu, available for dine-in and takeout 24 hours a day.

The Upstate Tavern

From local ingredients to local brews, the menu offers culinary creations that are time-honored, New York-inspired, and American classics prepared from scratch.

Tin Rooster Honky Tonk

At Tin Rooster, the pig is sacred, the beer is cold and the atmosphere is country Americana at its finest. Our BBQ features signature flavors that may start a finger-lickin' obsession.

Opals Confectionery

Indulge in fresh hot coffee, a just-baked muffin or house-made fudge at Opals. A tempting array of rich confections will satisfy your sweet tooth.

The Grille at Shenendoah

Grab a bite in this stone-and-cedar-style clubhouse. The Grille at Shenendoah features a full breakfast menu. Open seasonally with outdoor dining.

Tower Lounge

Enjoy a vibrant atmosphere and a wonderful selection of cocktails and nosh-ready snacks.

The Lodge Lounge

The bar provides panoramic views of the western sky overlooking The Great Lawn. This beautiful spot offers sunsets, spirits and savory spreads.

Award-Winning Golf

- Three world-class and two executive courses
- Group lessons available

Atunyote

Designed by Tom Fazio, Atunyote features gently rolling hills, small waterfalls and tree-lined fairways. This parkland setting will challenge your golf skills and excite your senses from start to finish.

Shenendoah

Designed by Rick Smith, Shenendoah is host to stunning scenery, wonderful routing and low country-style holes. Playing over 7,000 yards, Shenendoah challenges every golfer while offering playability for any skill level.

Kaluhyat

This Robert Trent Jones Jr. designed course features dramatic elevation changes and spectacular views. At 7,100 yards, accuracy is a must on one of the most challenging courses in New York State.

The Sportsplex at Turning Stone

Golf is always in season in our state-of-the-art indoor facility with 36 hitting stations, full short-game areas and expert private lessons available year-round.





Relaxation and Recreation

Outdoor Recreation

Salmon Acres

36 acres on the banks of the world-renowned Salmon River. This could well be the finest salmon fishing you'll ever experience.

The Cove at Sylvan Beach

A Good Housekeeping Family Travel Award winner, The Cove has everything you need for the perfect getaway. Cruise Oneida Lake in your included pontoon and enjoying weekly events.

Sylvan Beach Supply Co.

Located on beautiful Oneida Lake, Sylvan Beach Supply Co. offers rentals of boats, kayaks, paddle boards, fishing gear, bikes and more.





Spas

SkΛ:nā: The Spa at Turning Stone

SkΛ:nā: the Oneida word for peace, is where soothing treatments and modern amenities combine with American Indian cultural themes to create luxuriously unique spa experiences.

SkΛ:nā: was honored with the Forbes Travel Guide Four-Star Award, as well as the #1 Spa in New York by Spas of America.

Áhsi' Day Spa

Pass through the doors of Áhsi' Day Spa, the Oneida word for "awaken," and begin your personal journey toward relaxation and well-being. Services focus on the awakening of mind, body and spirit.

Áhsi' Wellness Center by Rome Health

Áhsi' Wellness Center by Rome Health offers personalized, physician-led treatments to help you look, feel and live better. Discover a new standard of expert care in services that support lasting results.

Property Map

Detail Specifications

Accommodations

- A1 The Crescent
- A2 Elevator To The Brook
- A3 The Brook
- A4 The Brook And The Tower Front Desk
- A5 The Lodge Front Desk

Conference Center

- M1 Saranac
- M2 Canandaigua
- M3 Chautauqua
- M4 Tuscarora
- M5 Cayuga
- M6 Onondaga
- M7 Seneca
- M8 Mohawk
- M9 Oneida

Entertainment

- E1 The Event Center
- E2 The Showroom
- E3 NY Rec & Social Club
- E4 Tin Rooster Honky Tonk
- E5 The Gig
- E6 Turquoise Tiger

Gaming

- C1 TS Guest Services
- C2 Golden Dragon
- C3 Keno
- C4 Casino Gaming Floor
- C5 Casino Cashier
- C6 Poker Room
- C7 Casino Blu
- C8 Turning Stone High Stakes Bingo
- C9 Gaming Commission
- C10 TS Sports
- C11 The Parlor - Members Only

Restaurants, Bars And Lounges

- R1 Alchemist Bar
- R2 Peach Blossom
- R3 The Food Hall
- R4 Bar Pino
- R5 Pino Bianco
- R6 Sushi Sushi
- R7 Emerald Restaurant
- R8 Opals Confectionery
- R9 Motif Bar & Lounge
- R10 7 Kitchens
- R11 The Upstate Tavern
- R12 TS Steakhouse (21st Floor of The Tower)
- R13 Bar Blu
- R14 Wildflowers
- R15 The Lodge Lounge
- R16 Tower Lounge
- R17 NY Rec & Social Club
- R18 Tin Rooster Honky Tonk
- R19 Salt (7th Floor of The Crescent)
- R20 The Pantry

Recreation

- P1 The Brook Pool
- P2 The Tower Fitness Club & Pool

Retail

- S1 Oneida Heritage
- S2 Polly Cooper
- S3 Juniper
- S4 Revel Supply
- S5 Willow & Jaye
- S6 The Kiosk
- S7 Smokin' 2
- S8 The General Store
- S9 Mr. Shop

Spa

- L1 Áhnsi' Day Spa
- L2 Áhnsi' Wellness Center
- L2 Ska:ná: Spa

SHENENDOAH CLUBHOUSE



FIRST FLOOR



SECOND FLOOR

- Clubhouse Area
- S2 The Grille At Shenendoah
- S3 Pro Shop

- Conference Area
- S4 Appalachian
- S5 Adirondack
- S6 Catskill

THE EVENT CENTER SECOND FLOOR

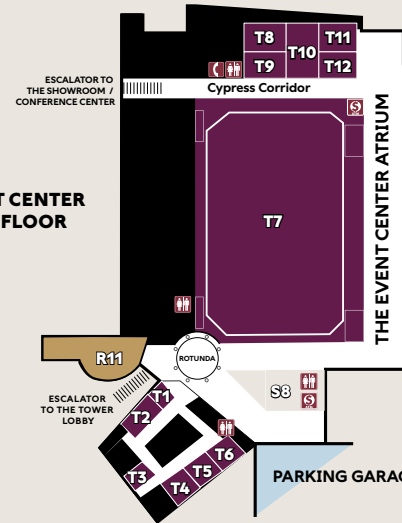

Convention Center

The Tower Meeting Rooms

- T1 Business Center
- T2 Meadow
- T3 Hawthorn
- T4 Willow
- T5 Oak
- T6 Briar

The Event Center

- T7 The Event Center

Cypress Conference Area

- T8 Cypress A
- T9 Cypress B
- T10 Cypress C
- T11 Cypress D
- T12 Cypress E

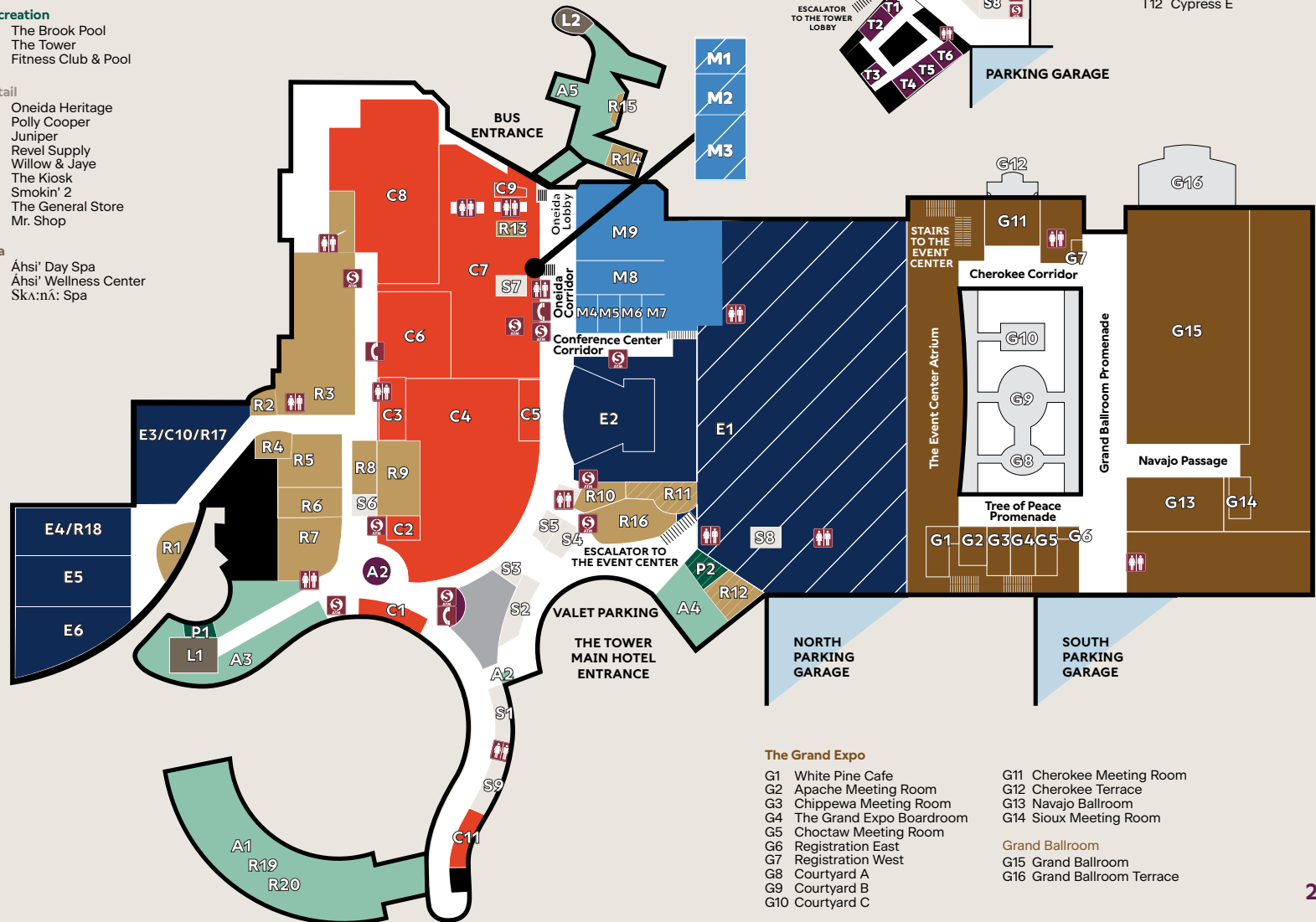

The Grand Expo

- G1 White Pine Cafe
- G2 Apache Meeting Room
- G3 Chippewa Meeting Room
- G4 The Grand Expo Boardroom
- G5 Choctaw Meeting Room
- G6 Registration East
- G7 Registration West
- G8 Courtyard A
- G9 Courtyard B
- G10 Courtyard C

- G11 Cherokee Meeting Room
- G12 Cherokee Terrace
- G13 Navajo Ballroom
- G14 Sioux Meeting Room

Grand Ballroom

- G15 Grand Ballroom
- G16 Grand Ballroom Terrace

Property Map

Overall Specifications

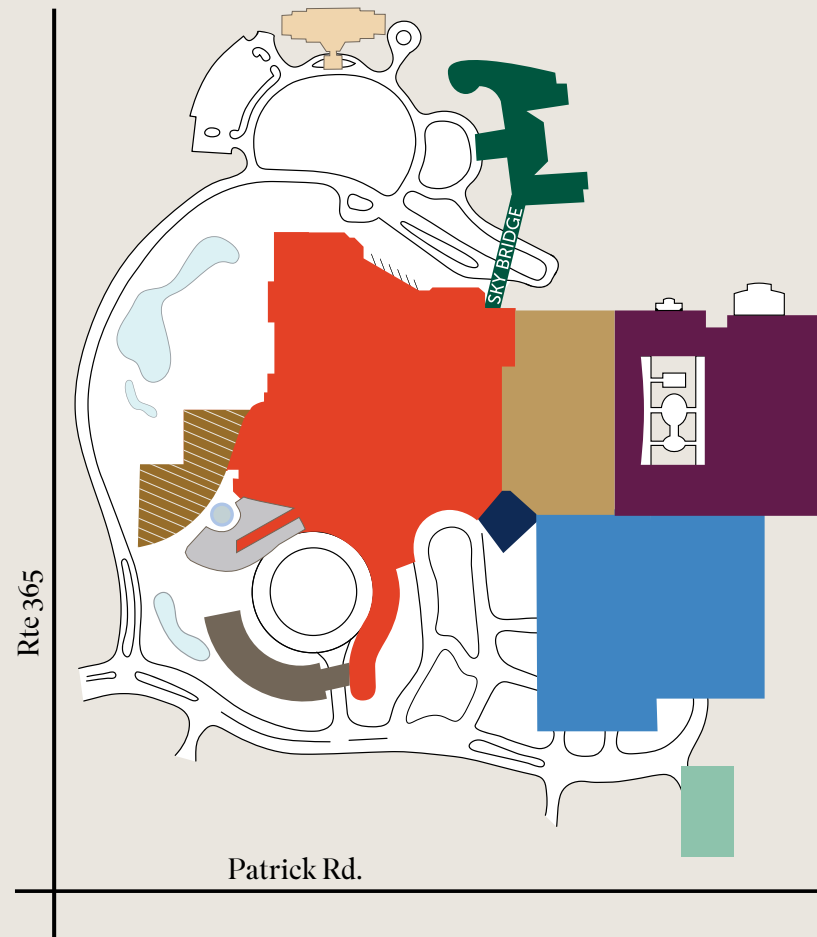

- | | | |
|--|--|---|
|  Casino |  The Brook |  Exit 33 |
|  The Event Center |  The Lodge and Skala Spa |  Sportsplex |
|  The Crescent |  The Grand Expo |  Parking Garages |
|  The Tower |  Shenendoah Clubhouse | |